

INSTALLATION INSTRUCTIONS

Concealed cistern equipped with a
water saving Dual flush valve



ENGLISH

Réf. W760B/C : SOLÉMUR® with universal support frame
Réf. 9770B : :

Réf. W751B/C : with self supporting frame
Réf. 9771B : :

Réf. W752B/C : with wall support frame

* except Ref. 9771B



TABLE OF CONTENTS

DESCRIPTION	2 to 5
SUPPORT FRAMES ADJUSTMENTS	6
INSTALLING THE SUPPORT FRAMES	7
1 INSTALLING THE WC connector	7
2 ADJUSTING THE FRAMES	7
3 FIXING THE FRAME AND CONNECTING THE DRAIN	8
4 ATTACHING THE PAN	9
5 CONNECTING THE WATER INLET	10
6 FITTING THE PANELING	11
7 CUTTING THE FLUSH PIPE CONNECTOR	12
8 CUTTING THE WC CONNECTOR	13
9 INSTALLING THE PAN	13
10 REMOVING THE TEMPLATE	14
11 INSTALLING THE OPERATING PLATE	14
12 CONNECTING THE OPERATING PLATE TO THE MECHANISM	14
MAINTENANCE OPERATIONS	15
WATER LEVEL ADJUSTMENTS	16



UNIVERSAL SUPPORT FRAME REF. W760B/C
OR SELF SUPPORTING FRAME REF. W751B/C

Parts List

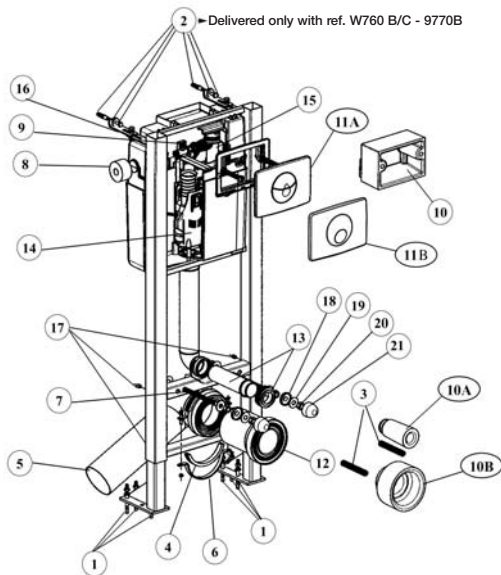

N°	Description	Product code	N° of parts
1	Pin with washer	9852036	x 6
2	Pin – washer – screw subassembly	9873603	x 2
3	Protective ringed tube, threaded rods	9831268	x 2
4	Collar noise insulation	9835058	x 2
5	100 mm dia. WC connector	0709063	x 1
6	WC connector clamp	9873202	x 1
7	Threaded rod M 12 x 200	9852030	x 2
8	Water inlet insulation	9835056	x 1
9	Stop cock G 3/8"	9873870	x 1
10	Tiling set	9835062	x 1
10A	Flush pipe connector protection	9835063	x 1
10B	WC connector protection	9835064	x 1
11A	Complete white operating plate	0709140	x 1
11B	Complete white operating plate	0709176	x 1
12	WC connector	0709065	x 1
13	Flush pipe connector	0709089	x 1
14	Dual flush mechanism	2V01	x 1
15	Silent float valve	1590	x 1
16	Right-angle bracket	9873227	x 4
17	Needle screw	9852021	x 4
18	Spacer	9831269	x 2
19	Washer 23 x 13 x 2	9852031	x 6
20	Hex nut M12	9852032	x 6
21	Nut cap	9833306	x 2

OU

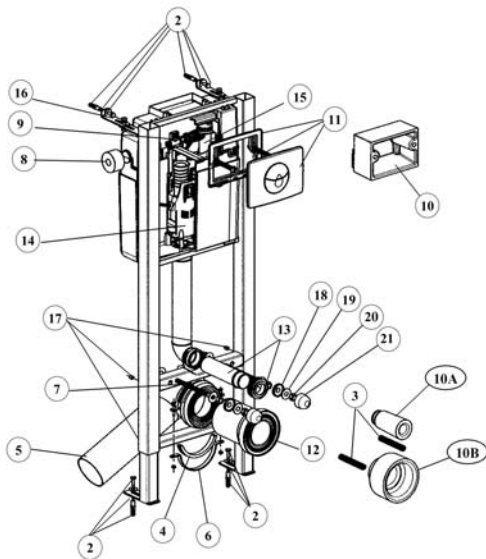

N°	Description	Product code	N° of parts
2	Pin – washer – screw subassembly	9873603	x 4
3	Protective ringed tube, threaded rods	9831268	x 2
4	Collar noise insulation	9835058	x 2
5	100 mm dia. WC connector	0709063	x 1
6	WC connector clamp	9873202	x 1
7	Threaded rod M 12 x 200	9852030	x 2
8	Water inlet insulation	9835056	x 1
9	Stop cock	9873870	x 1
10	Paneling install template	9835062	x 1
10A	Tiling set	9835063	x 1
10B	WC connector protection	9835064	x 1
11	Complete white operating plate	0709140	x 1
12	WC connector	0709065	x 1
13	Flush pipe connector	0709089	x 1
14	Dual flush mechanism	2V01	x 1
15	Silent float valve	1590	x 1
16	Right-angle bracket	9873227	x 4
17	Needle screw	9852021	x 4
18	Spacer	9831269	x 2
19	Washer 23 x 13 x 2	9852031	x 6
20	Hex nut M12	9852032	x 6
21	Nut cap	9833306	x 2

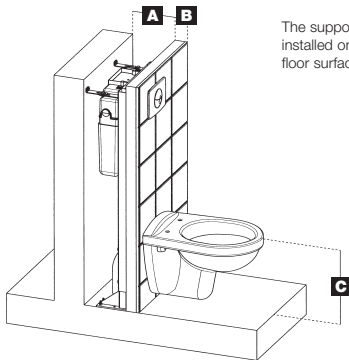

The support frames can be installed on any type of hard floor surfaces

A = 150 mm minimum, 226 mm maximum

B = 15 mm minimum, 70 mm maximum

C = 40 cm (recommended when compatible with your pan) or 45 cm for disabled people)

D = 1035 mm minimum, 1330 mm maximum
= 1035 mm minimum, 1230 mm maximum on version 9771B

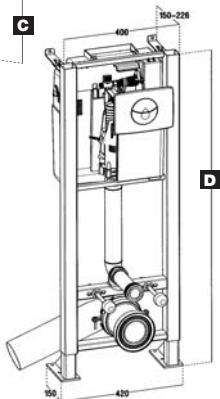

6

1 INSTALLING THE WC CONNECTOR

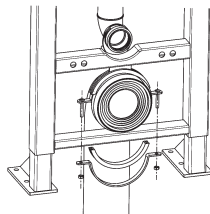

Fix the supplied half collar and the 2 insulators.

2 ADJUSTING THE FRAMES

After adjusting to the right height, tighten the needle screws ; assemble and adjust the right-angle brackets (for a wall mounted installation).



The pan height position will be final.

WALL SUPPORT FRAME REF. W752B/C

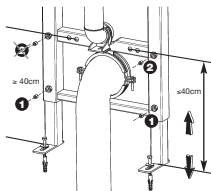

SELF SUPPORTING FRAME REF. W751B/C - 9771B
UNIVERSAL SUPPORT FRAME REF. W760B/C - 9770B

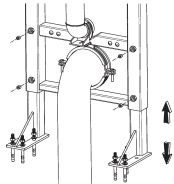

WALL SUPPORT FRAME REF. W752B/C
UNIVERSAL SUPPORT FRAME REF. W760B/C - 9770B

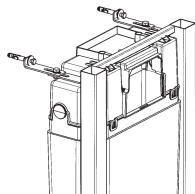

7

3

FIXING THE FRAME
AND CONNECTING THE DRAIN

Adjust the connector by cutting the straight section, if necessary.



An adaptor pipe sleeve to fit to the piping may be necessary (not supplied).

WALL SUPPORT FRAME REF. W752B/C

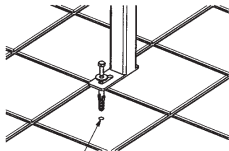

10 mm dia. drilled holes

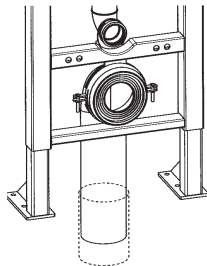

Install the frame in its final position to validate the adjustments and mark where the holes are to be drilled.
Drill, glue the pipe and permanently fasten the frame.

SELF SUPPORTING FRAME REF. W751B/C - 9771B
UNIVERSAL SUPPORT FRAME REF. W760B/C - 9770B

WALL SUPPORT FRAME REF. W752B/C
UNIVERSAL SUPPORT FRAME REF. W760B/C - 9770B

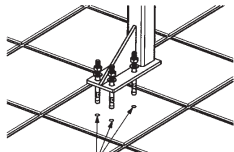

8 mm dia. drilled holes

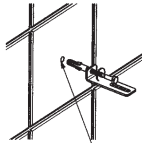

10 mm dia. drilled holes

8

4

ATTACHING THE PAN

Select the distance between the fastening rods

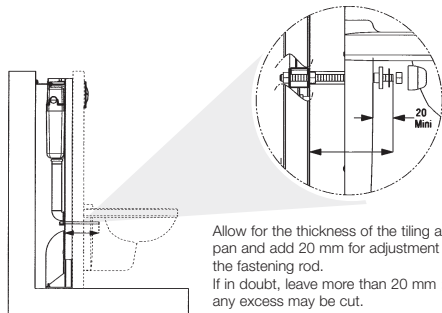
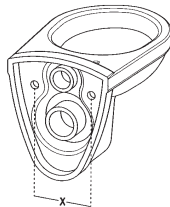
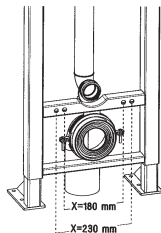

Allow for the thickness of the tiling and pan and add 20 mm for adjustment of the fastening rod.
If in doubt, leave more than 20 mm ; any excess may be cut.

9

5 CONNECTING THE WATER INLET

It is recommended to connect the water inlet directly to the stop cock. If a flexible tube is used (not supplied), the two fittings at the flexible tube ends must be installed inside the cistern for safety in case of a leak.

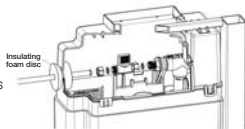

The water inlet can be installed to the left or right of the cistern by breaking the feed hole's protective washer (note : factory mounted for a left side water inlet).

Refer to the maintenance operations to see how to change the float valve for a right side water inlet installation.



Bleeding the water feeding piping :

Remove the float valve by pulling on the tab and then lifting the float valve and its support.

Bleed to evacuate impurities. Make sure the water inlet is sealed correctly to prevent leaking and reinstall the float valve.

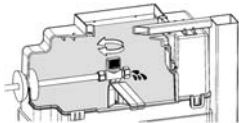

It is recommended to test the complete assembly (with the pan and connectors) to make sure it is leak-proof before installing the tiling (replace the paneling between the frame and the pan by wedges). Carry out a few complete toilet cistern filling and flushing cycles.

6 FITTING THE TILING

Install the polystyrene template.
Warning : Place tiling flush with template.

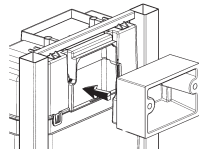

Install the threaded rod protections (protective ringed tubes) and expanded polystyrene plugs.

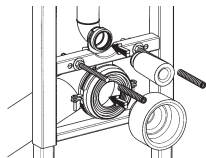

This system offers you a large number of personalized finish choices and the tiling structure can be completed with many solutions :

- with square plaster panels, bricks, etc.
- with marine fiberboard panels
- with 2 superposed BA13 plates
- with 1 BA18 waterproof plate

The tiling is installed between steps 6 and 7 of the installation guide.

Regardless of the type of support you select, you will have to cut into the support (plasterboard, fiberboard, etc.) and the so-called paneling (tiling, wall paper, etc.) to have enough space to install :

- * the pan feed tube (13) ;
- * the straight connecting sleeve (12) ;
- * the expanded polystyrene install template (10). This template will delimit the space required to install the operating plate.

Use the cut template if represented on the back of the cardboard box or delivered in the cardboard box to determine the respective locations and the size of the various spaces to be cut in the tiling.

AFTER TILING :

To facilitate the operations described in steps 7, 8 and 9, apply some grease to the seals of each fitting or tube.

7 CUTTING THE FLUSH TUBE CONNECTOR

Push the tube fully in.

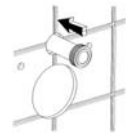

Draw the mark M1 as indicated.



Push the tube fully into the bowl.

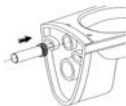

Draw the mark M2 as indicated.

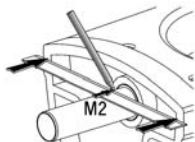

Cut the tube as indicated. Measure the dimension Y which will be used for the cutting of the drain sleeve in step 8.

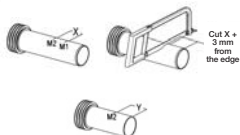

12

8 CUTTING THE WC CONNECTOR SLEEVE

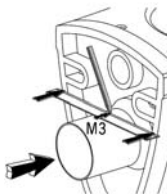

Push the sleeve fully into the pan.

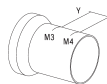

Draw the marks M3 and M4. Cut as indicated.

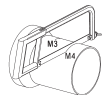

Bevel the connector and the tube.

ENGLISH

9 INSTALLING THE PAN

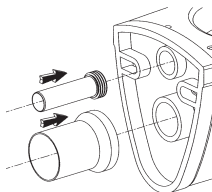

Push the tube and sleeve fully into the pan.

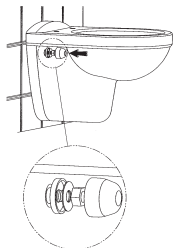

Install the pan on the fastening rods.

13

10 REMOVING THE TEMPLATE

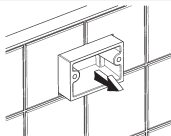

11 INSTALLING THE OPERATING PLATE

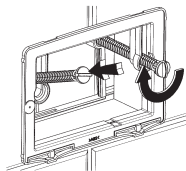

Install the support frame :
Remove the screws from the frame, fettle the screw head and the frame.
Insert the screws slanted as shown on the drawing.
Tighten down to the last threads.

12 CONNECTING THE OPERATING PLATE TO THE MECHANISM

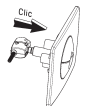

Clipping in the button.

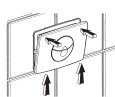

Installing the plate.

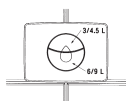

Unclipping the button (to remove the plate, if necessary).



MAINTENANCE OPERATIONS

Removing the float valve

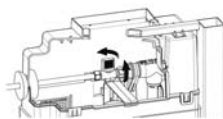

- 1 Close the water inlet.
- 2 Loosen the float valve nut.



- 3 Remove the float valve and its support.

Removing the mechanism



- 1 Pull on the tab and lift the latch.

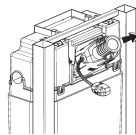

- 2 Remove the mechanism to replace its seal, if necessary.

- 3 Reinstall the mechanism and the latch.

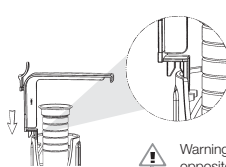

Warning : Make sure that the latch is blocked in its grooves immobilizing the mechanism.

Do not do this.



Warning : The mechanism's cable must be opposite the float valve.

WATER LEVEL ADJUSTMENTS

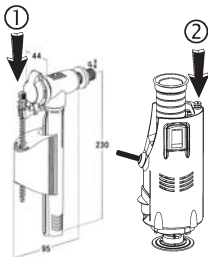

Adjust the water level in the cistern using the float valve screw **1**.

Adjust the “economical” flush using the mechanism screw **2**.

Tightening = decreases the “volume of small flush”

Loosening = increases the “volume of small flush”

The product is delivered adjusted at the factory to 3 liters / 6 liters (small / large volume flushes, respectively).